

SWITCH TILTER

The Switch Tilter is the perfect switch transport wagon for modular switch replacement.

The prefabricated switch parts can be transported from the switch factory to the construction site in an environmentally friendly way using the Switch Tilter in regular freight trains.

At the construction site, unloading can be performed at a convenient location for installation of the switch. The low height of the Switch Tilter's loading platform creates sufficient space for unloading under existing overhead lines. The ability to shift the loading platforms laterally enables unloading even in very confined conditions, e.g. in tunnels.

Switch Tilters are optimised according to customer requirements and designed and approved in accordance with the applicable regulations.

The Switch Tilter TSI has the TSI WAG approval valid throughout Europe. The Switch Tilter AAR was designed and supplied in accordance with AAR standards.

BASIC DESIGN CRITERIA

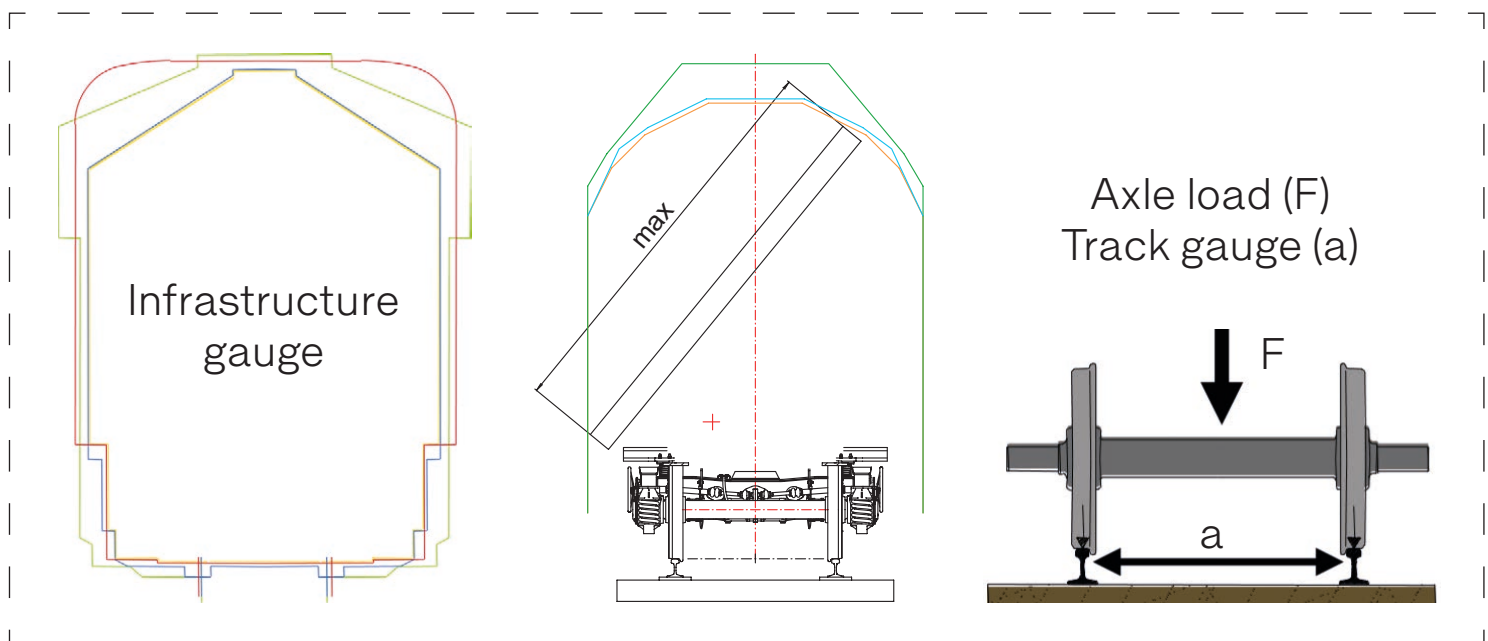





MODULAR DESIGN OF SWITCH TILTER

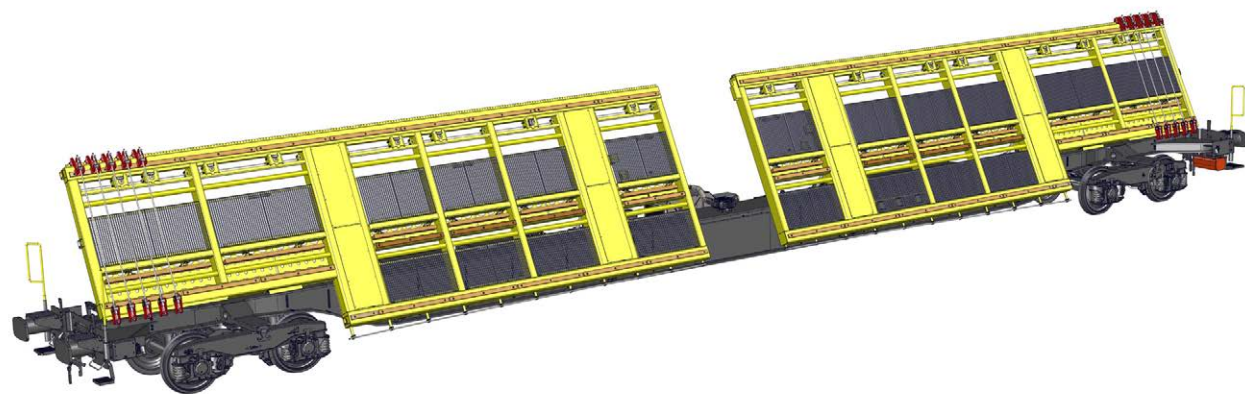

OPTIONAL FUNCTION

LATERAL SHIFTING OF THE LOADING PLATFORM

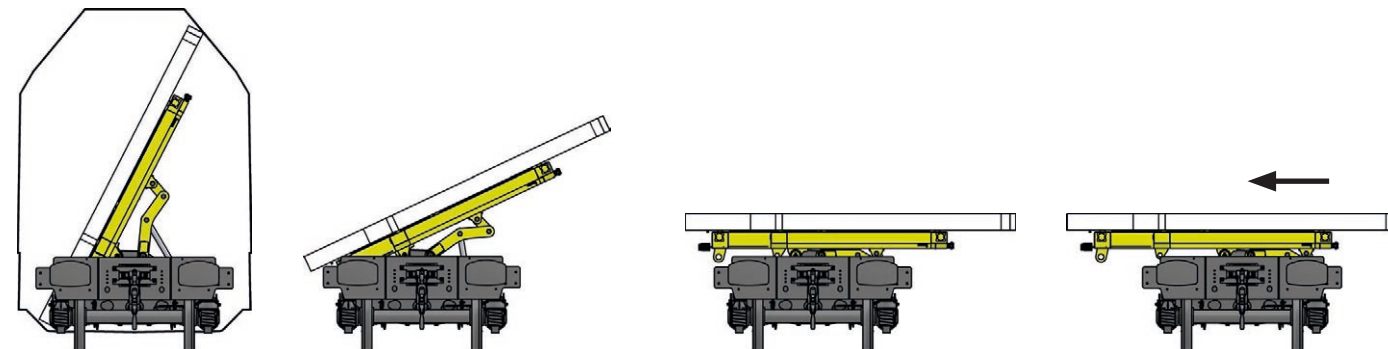

DRAW AND BUFFING GEAR



Buffer + screw coupling
acc. to EN Standards

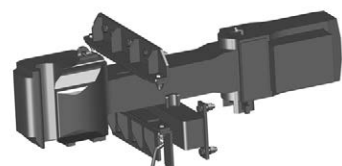

Center buffer coupler
acc. to AAR standards

BOGIE WITH INTEGRATED BRAKE UNIT



Bogie type Y25
acc. to EN standards

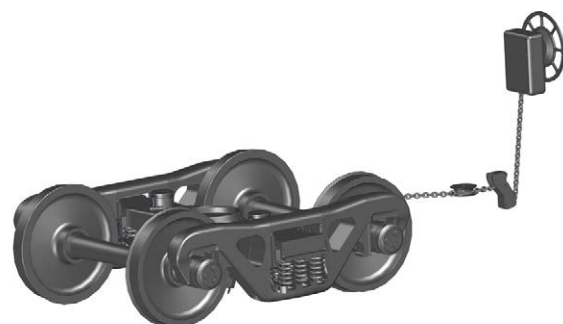

3 piece bogie
acc. to AAR standards

POWER PACK

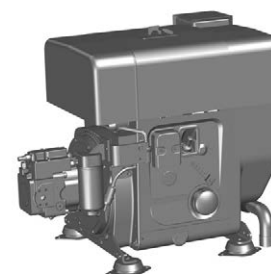

Diesel engine + hydraulic pump
EU stage V / EPA IV final



Electric drive + hydraulic pump
emission-free

LOAD FIXING SYSTEM

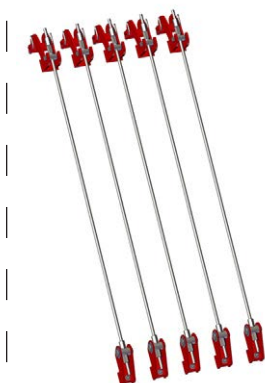

Universal

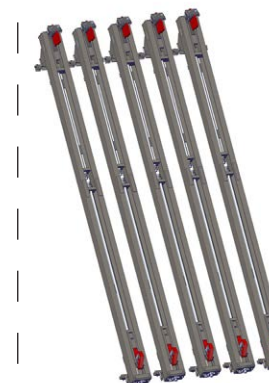

Ground operated

